

SP90 Manual Airless Spray Gun

- ✓ 500 Bar MWP
- ✓ 4 finger trigger
- ✓ gun handle filter (included)
- ✓ CE marked
- ✓ swivel fluid inlet
- ✓ choice of 1/4 NPS / 1/4 BSP or M16 fluid inlet connection

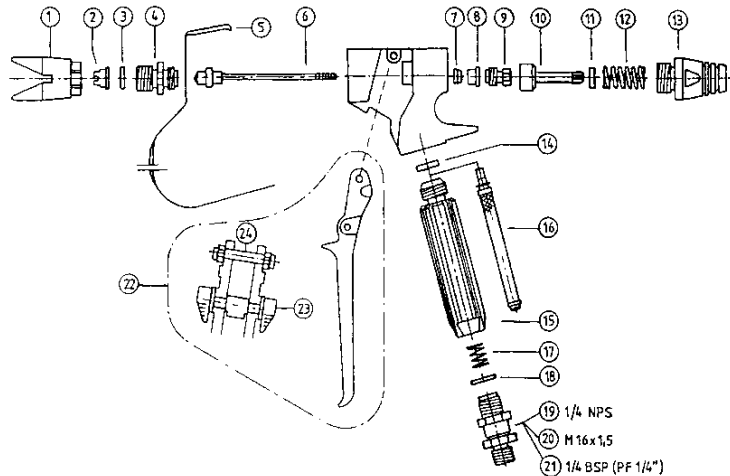

SP90 illustrated with 88-557 Speedy MkV (rated 517 Bar) - see page 54

SP 90 Models

TYPE REF	DESCRIPTION
90-500/00	SP90 manual spray gun 500 Bar rated. 1/4 NPSM male fluid connection inc speedy + tip 11/16 x 16
90-501/00	SP90 manual spray gun 500 Bar rated. M16x1.5 male fluid connection inc speedy + tip 11/16 x 16
90-502/00	SP90 manual spray gun 500 Bar rated. 1/4 BSP male fluid connection inc speedy + tip 11/16 x 16
90-530	SP90 manual spray gun 500 Bar rated. 1/4 NPSM male fluid connection inc speedy + tip 7/8 x 14

Spare parts for SP90 spray guns

POS. REF	DESCRIPTION	POS. REF	DESCRIPTION
1	90-401 Guard and nut assembly	14	90-414 Handle gasket
4	90-404/2 Fluid tip diffuser 7/8 x 14	15	90-415 Handle
4	90-404/7 Fluid tip diffuser 11/16 x 16	17	90-417 Filter spring
5	90-405 Guard	18	90-418 Gasket
6	90-406 Needle	19	90-419 Swivel 1/4 NPS
7	90-407 Needle packing seal	20	90-420 Swivel M16 x 1.5
8	90-408 Pressure washer	21	90-421 Swivel 1/4 BSP
9	90-409 Needle packing screw	22	90-422 Trigger assembly
10	90-410 Cylinder	23	90-423 Trigger lock assembly
11	90-411 Locking nut	24	90-424 Trigger pin and nut
12	90-412 Gun spring		90-430 Needle repair kit (90-406/408/409/411)
13	90-413 Spring cap		90-300 Repair kit