



Top Quality - Best Results

#### SWITZERLAND

EXIT SA / EXITFLEX SA  
CH-1196 Gland Switzerland  
Tel: +41 22 9999299  
Fax: +41 22 3642505  
e-mail: info@exitflex.com  
www.exitflex.com

#### GERMANY

Exitflex GmbH  
Tel: +49 911 9983046  
Fax: +49 911 9983045  
e-mail: info@exitflex.de  
web: www.exitflex.de

#### UNITED KINGDOM

Exitflex (UK) Ltd  
Tel: +44 1202 478334  
Fax: +44 1202 488110  
e-mail: sales@exitflex.co.uk  
web: www.exitflex.co.uk

#### USA

Exitflex USA  
Tel: +1 732 512 9141  
Fax: +1 732 512 9145  
e-mail: mail@exitflexusa.com  
web: www.exitflexusa.com

#### SWEDEN

Exitflex AB  
Tel: +46 300 31970  
Fax: +46 300 564780  
e-mail: info@exitflex.se.  
web: www.exitflex.se

#### AUSTRALASIA & ASIA

Exitflex Dana Marketing  
Pty Ltd  
Tel: +61 3 9752 8918  
Fax: +61 3 9011 6179  
e-mail:  
dandn@iprimus.com.au

#### POLAND

Exitflex PL Sp.zo.o  
Tel: +41 58 6207041  
Fax: +41 58 6207041  
e-mail: biuro@exitflex.pl  
www.exitflex.com  
www.exitflex.pl



OTHER PRODUCTS AVAILABLE  
FROM EXITFLEX INCLUDE:

- AIRLESS SPRAY TIPS
- AIR ASSISTED AIRLESS SPRAY TIPS
- AIRLESS SPRAY GUNS
- AIRLESS PAINT SPRAY HOSES (HIGH PRESSURE)
- AIR & FLUID HOSES (LOW PRESSURE)
- HOSE FITTINGS
- COUPLINGS & ADAPTORS
- MANIFOLD/SUCTION/IN-LINE FILTERS
- SUCTION SYSTEMS
- PAINT AGITATORS
- HIGH PRESSURE SWIVELS
- AIR FED BREATHING APPARATUS
- SPRAY GUN EXTENSIONS – AIRLESS AND CONVENTIONAL
- GAUGES
- HIGH & LOW PRESSURE FLUID VALVES AND REGULATORS
- HVLP TURBINE HOSES
- QUICK RELEASE CONNECTIONS – AIR & FLUID

YOUR CONTACT FOR SPARES AND SERVICE

**EXIT FLEX™**

# TRI-A AIR ASSISTED AIRLESS SPRAY GUN



## WARNING – HIGH PRESSURE DEVICE Please Read These Instructions Before Using This Equipment



### MODELS AND SPECIFICATIONS

All TRI-A guns are rated at 140 bar (2030 psi) with reversible system.

#### TRI-A AIR ASSISTED AIRLESS MANUAL PRODUCTION GUN

83-001 1/4 BSP(M) air inlet 1/4 BSP(M) fluid inlet  
Gun weight including reversible unit 725 grams.

#### DESCRIPTION

The TRI-A air assisted airless gun is designed for demanding industrial applications.

High quality coupled with high material savings, ease of maintenance and a reversible tip, TRI-A brings the air assisted airless user into the 21st century.

#### IMPORTANT

To ensure your TRI-A gun reaches you in first class condition protective coatings have been used. Flush thoroughly with compatible solvent before use.

Whilst these guns may be used with the most common coatings and finishing materials they are not designed for use with highly corrosive or highly abrasive material.

If the guns are used with materials which are abrasive or corrosive you should expect to have to frequently and thoroughly clean and lubricate and where necessary replace worn parts.

### WARNINGS

#### Halogenated Hydrocarbon Solvents

For example 1.1.1-TRICHLOROETHANE AND METHYLENE CHLORIDE can chemically react with aluminum and galvanised or zinc coated parts and cause an explosion hazard. Read the label or data sheet for the material you intend to spray for your own safety.

Do not use spray materials containing these solvents with this equipment.

### WARNING

#### FLUID INJECTION HAZARD

The pressures in use in airless spraying equipment frequently up to 7250 psi can penetrate the skin and inject potentially large quantities of toxic fluid into the body. Such an injection at its worst could cause the loss of a limb or other permanent disability. Extreme caution must be exercised when using any airless spray equipment. Any injection must be treated seriously and promptly. Only trained personnel should use airless spray equipment.

**NEVER** aim the gun at any part of the body or at any person under any circumstances.

**NEVER** permit any part of the body to come into contact with the fluid stream at any point.

**NEVER** dismantle the equipment without first shutting off all air and fluid supplied and then not before releasing all the pressure in the system.

**NEVER** leave the gun unattended or unlocked when not in use. Always apply the trigger lock.

**NEVER** attempt to back flush the gun by holding a rag in front like you can with a conventional spray gun. You cannot back flush an airless gun. Don't attempt it.

**ALWAYS** release the pressure before trying to remove a blocked tip which has failed to clear on reversal.

**NEVER** remove a blocked tip when the system is pressurised.

**CAUTION** Because it is possible to generate static electricity with airless systems which could in an extreme case result in an electrical spark and potential explosion, be sure to ground your equipment and where possible earth the equipment being sprayed. Always use conductive hoses to ensure any static can run to ground. Refer to ATEX directive for guidance

### SAFETY FEATURES

#### TRIGGER LOCK

To prevent accidental discharge of the gun particularly when the spray tip is removed for whatever purpose.

#### CAUTION

The operating instructions for the TRI-A reversible tip system are included with the units when supplied.

**ALWAYS FOLLOW THE INSTRUCTIONS PROVIDED.**

## INSTALLATION

Simply connect the correct pressure rated air and fluid hoses with the correct threaded connection to the correct inlet connections, ie air to gun handle base and fluid to filter base. Take care. Do not fit incorrectly. Fluid hose is high pressure

Prior to connecting the fluid hose, ensure that a filter of the required screen is fitted in the housing.

The filter assembly and fluid connection must be correctly tightened to ensure there is no possibility of a leak at the joints. Failure to do so correctly could result in liquid penetration with all the problems that such an injury can cause.

## OPERATION

The *TRI-A* combines airless and air spray concepts.

The spray tip atomises the material in a similar way to a standard airless tip but at a lower pressure. Air from the aircap atomises the fluid further and completes the atomisation of the tails into the spray pattern.

The spray gun has a built in lead and lag operation. When the trigger is operated the gun emits air before fluid and when the trigger is released the fluid is shut off before the air.

The performance of the gun is affected by a number of factors. The spray tip type, orifice and angle, the material pump volume and pressure and the supply hose bore and length and the filter mesh.

Be sure to choose the required correct combination of these items to get the best from your spray gun.

Correctly prepare the material to be sprayed in accordance with the manufacturers recommendations.

Prime the pump and set it ready to work in accordance with the manufacturers recommendations.

Test spray a small area, adjust the pump pressure or change the spray tip as necessary to achieve the result required.

Always use your system at the lowest practical pressure achievable without 'tails' in the spray pattern.

Correct use of the gun gives the best and cleanest result. Keep the gun perpendicular to the surface being sprayed and do not arc the gun at the end of the spray stroke, this causes excessive overspray and an uneven finish.

Correct recommended gun to application surface distance is 300 - 380mm (12 - 15in)

The following types of reversible tips are available for the *TRI-A* gun; standard, superfine and twin tip. These can produce vertical and horizontal spray patterns according to how the air cap is set on the gun. Choose the configuration most suitable for your application and set accordingly.

The standard *TRI-A* reversible tip system can be rotated from vertical to horizontal without removal from the gun.

The *TRI-A* superfine system is recommended as your first choice for use with your *TRI-A* gun to ensure top quality performance time after time. Please refer to *TRI-A* tip system literature for further details.

## PREVENTATIVE MAINTENANCE

Clean the fluid passages of the gun whilst cleaning the material pump and hoses.

**NEVER** attempt to back flush the gun by holding a rag over the front of the gun then pulling the trigger. It is not possible with air assisted airless guns to back flush and it is very dangerous to attempt to do so.

Wash the exterior of the gun with a suitable solvent and a brush or rag. Dry off afterwards before storing. Do not immerse the gun in solvent as this destroys any lubricant on the parts.

When using *TRI-A* tips, if the orifice is blocked, just reverse to clear, never use hard blunt instruments which can damage the tip orifice and render the tip useless. If firmly blocked use an EXITFLEX 36-701 or 36-703 tip cleaning needles designed for the job.

## ROUTINE MAINTENANCE

It is recommended that at the end of each working period the gun should be flushed through with compatible solvent.

When stopping the system to carry out operations on the unit, or when stopping at the end of the working day, the high pressure inside the unit must be completely discharged. When the main air inlet is shut off, the air is automatically discharged from the pump motor.

### WARNING

The product in the flexible fluid hose is still under pressure. Always relieve pressure from system following pump manufacturers procedures

The routine maintenance of the *TRI-A* gun is simple and does not require special operations because its components do not need to be lubricated. Clean the gun daily or at the end of each working session so that product residue will not dry out on its internal surfaces thus ensuring long term efficiency.

### CLEANING

Unscrew the air cap retaining ring, remove the air cap and remove the reversible nozzle. Place all components in solvent. Carefully clean the nozzle, dip it in solvent to dissolve residues inside of it. Blow compressed air through it from the front to eliminate all traces of material.

The tip must be repositioned with its gasket. Clean the head of the gun and the tip of the nozzle with the brush provided, at least once a week.

**DO NOT USE POINTED METAL OBJECTS TO CLEAN CLOGGED PASSAGES. THIS MAY DAMAGE THEM, REDUCING THE SPRAYING QUALITY OF YOUR *TRI-A***

Clean the body of the pump with a cloth soaked in solvent.

In case industrial washers are used to clean the gun, close the fan adjustment and the needle adjustment tightly by turning them clockwise in order to avoid solvent infiltration, which may in the long run damage gaskets.

Periodically lubricate the threaded parts such as the air cap, retaining ring, the needle adjustment and the air valve cap (including the shaft) with a thin layer of synthetic oil, in order to avoid seizing up caused by the effect of solvents on gun components.

**THE LUBRICANTS USED MUST NOT CONTAIN SILICONE. EXITFLEX SPRAY GUN LUBRICANT PART NUMBER SGL-50 IS SILICONE FREE.**

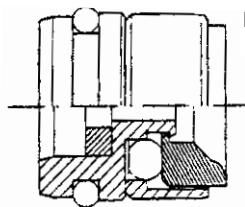

Item 5 83-011 TRI-A Swivel Seat Assembly detail

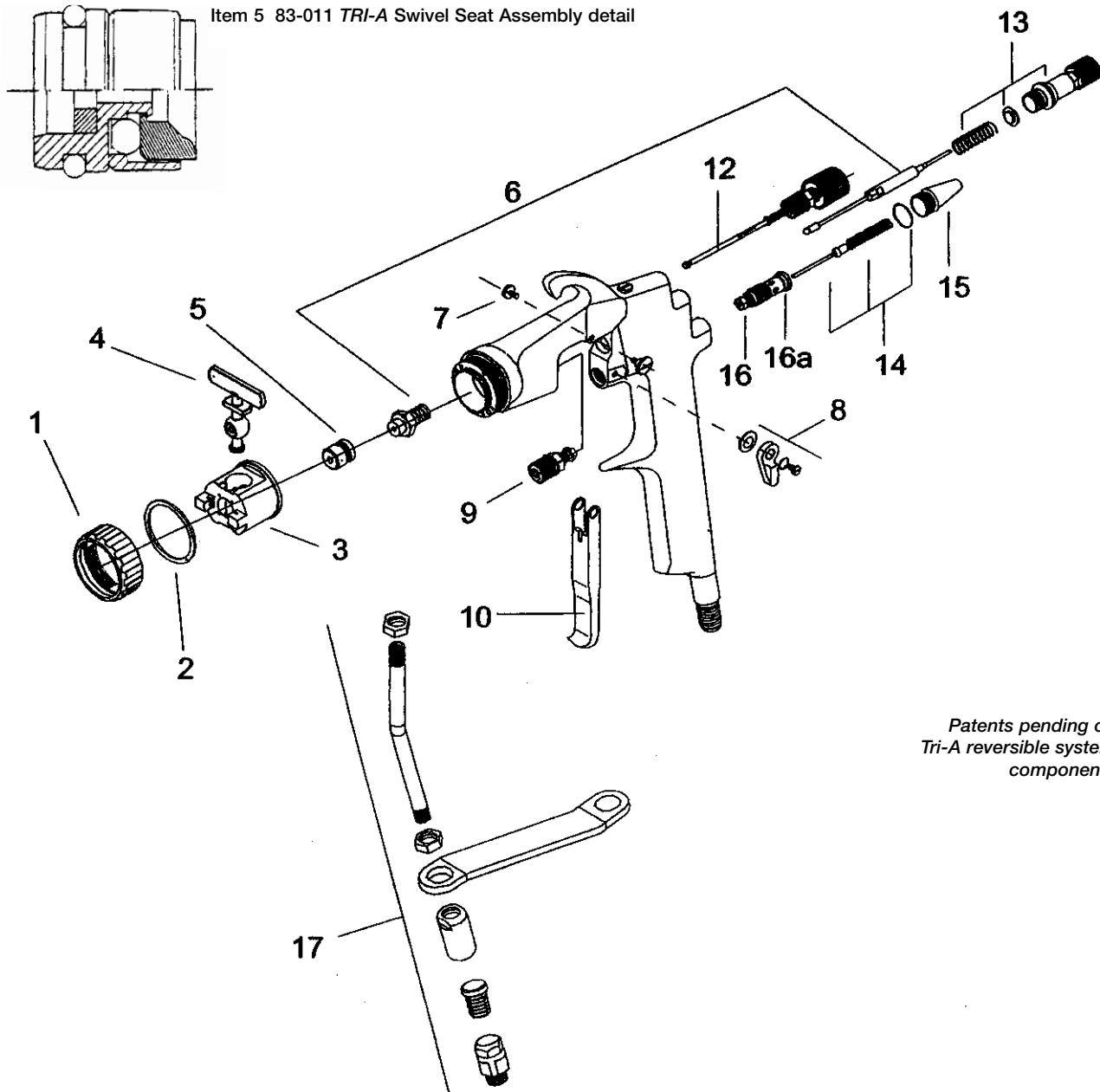

Patents pending on  
Tri-A reversible system  
components

POS	CODE	DESCRIPTION
1	83-401	AIR CAP RETAINING RING
2	83-402	FRICTION RING PTFE
3	83-008	AIR CAP
4	83-015	STANDARD BALL TIP
5	83-011	TRI-A SWIVEL SEAL ASSY
6	83-404/83-411-K	NEEDLE NOZZLE KIT
7	83-410	TRIGGER SCREW
8	83-437	TRIGGER LOCK KIT
9	83-407-K	PACKING GLAND ASSY
10	83-441-K	TRIGGER WITH SCREWS
12	83-412	FAN CONTROL
13	83-416-K	NEEDLE SPRING AND HOUSING KIT
14	83-419-K	AIR VALVE KIT
15	83-417	AIR VALVE CAP
16	83-422	AIR VALVE BODY
17	83-442-K	FILTER TUBE ASSEMBLY
19	83-444	NYLON BRUSH

**83-445 KIT GASKETS AND SPRINGS**

NOTE: ITEMS NOT SOLD SEPARATELY

QUANTITY	DESCRIPTION
1	TEFLON FRICTION RING
1	CAP AIR SEPARATING GASKET
1	TEFLON SEAL FOR SPRAYING NOZZLE
1	HEAD CONE PACKING
1	PACKING NEEDLE SPRING
1	FLAT RING
1	AIR VALVE STUFFING BOX SHAFT
1	AIR VALVE SPRING
1	O RING 2037
1	BASE FOR NEEDLE SPRING
1	O RING 3030 (16a)
1	NEEDLE SPRING
1	COMPLETE AIR VALVE SHAFT